

### LEGEND

- S — S — EXISTING SEWER
- SD — SD — EXISTING STORM DRAIN
- G — G — EXISTING GAS
- E — E — EXISTING ELECTRICAL

### NOTES:

- THESE UTILITY LOCATIONS ARE APPROXIMATE, BASED ON AVAILABLE CITY UTILITY AND MOUNTAIN FUEL COMPANY DRAWINGS. CONTRACTOR SHALL VERIFY THESE LOCATIONS IN THE FIELD PRIOR TO BEGINNING ANY EXCAVATION WORK.
- UP&L RECORDS SHOW NO UNDERGROUND POWER LINES ON SITE. ALL OVERHEAD ELECTRICAL LINES ARE NOT SHOWN ON THIS DRAWING. COORDINATE WITH PARK MAINTENANCE FOR CONTROLLER POWER SOURCES.
- CONTRACTOR SHALL CONTACT BLUE STAKES FOR UNDERGROUND UTILITY LOCATION MARKING PRIOR TO ANY EXCAVATION WORK.

NOTE:  
LOCATION OF SEWER FROM MAINTENANCE/GREENHOUSE BUILDINGS NOT KNOWN. LOCATE IN FIELD TO AVOID DAMAGE DURING EXCAVATION.

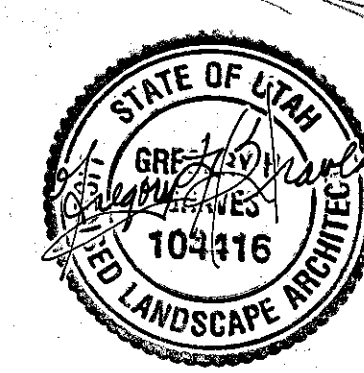
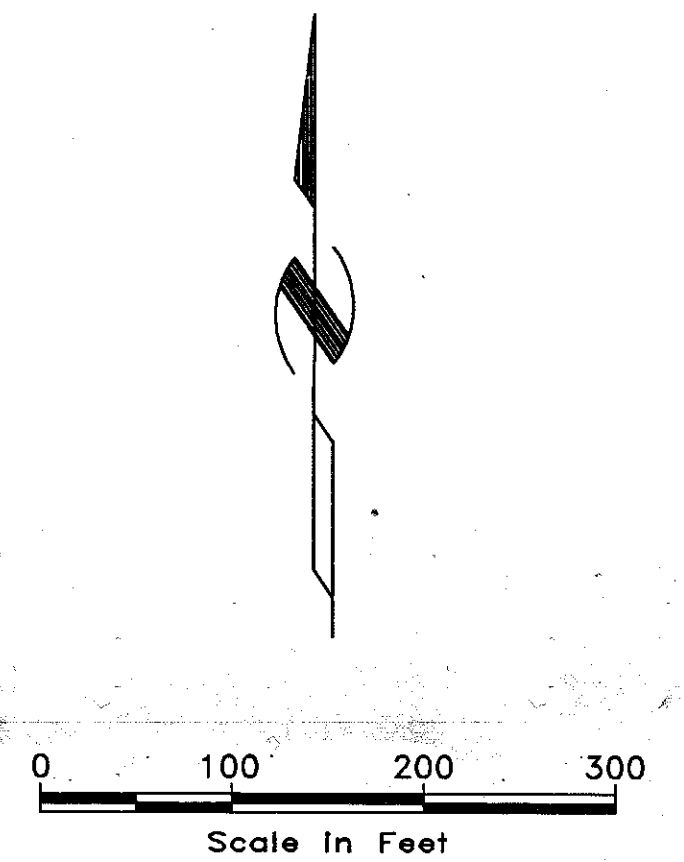

SUGAR HOUSE PARK AUTHORITY	
SUGAR HOUSE PARK IRRIGATION MASTER PLAN EXISTING UTILITIES	
<b>BINGHAM ENGINEERING</b> SALT LAKE CITY - (801) 532-2520	Design: GHG Drawn: STA Checked: _____ Reviewed: _____
	Date: NOV. 1993    Proj. #: 1823-006    Sht. 1 of 17

Rev.	By	Date	Remarks

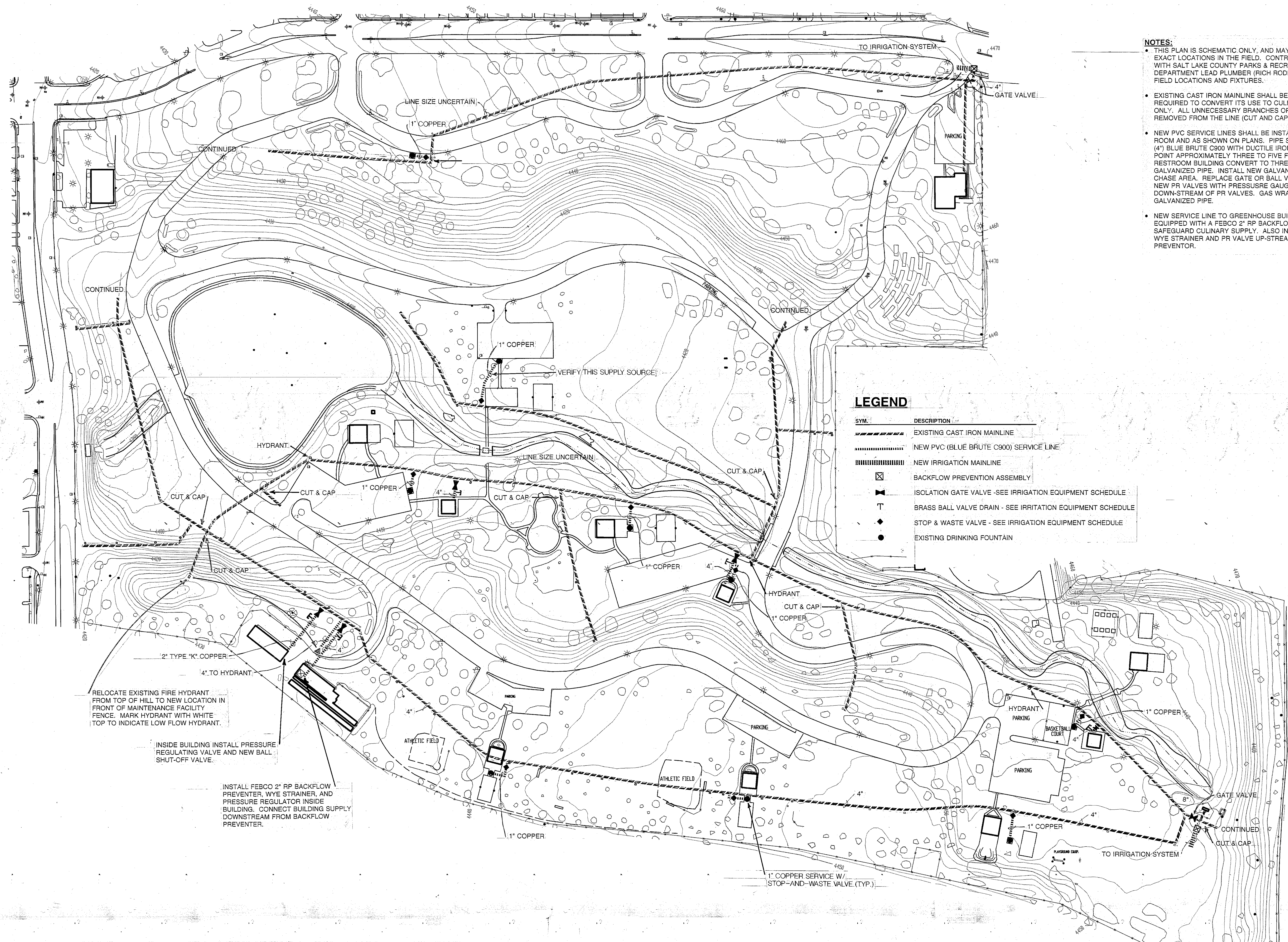

**NOTES:**

- THIS PLAN IS SCHEMATIC ONLY, AND MAY NOT REPRESENT EXACT LOCATIONS IN THE FIELD. CONTRACTOR SHALL WORK WITH SALT LAKE COUNTY PARKS & RECREATION DEPARTMENT LEAD PLUMBER (RICH RODRIGUEZ) TO VERIFY FIELD LOCATIONS AND FIXTURES.
- EXISTING CAST IRON MAINLINE SHALL BE MODIFIED AS REQUIRED TO CONVERT ITS USE TO CULINARY SUPPLY LINE ONLY. ALL UNNECESSARY BRANCHES OR SPURS SHALL BE REMOVED FROM THE LINE (CUT AND CAP AS REQUIRED).
- NEW PVC SERVICE LINES SHALL BE INSTALLED TO EACH REST ROOM AND AS SHOWN ON PLANS. PIPE SHALL BE FOUR INCH (4") BLUE BRUTE C900 WITH DUCTILE IRON FITTINGS. AT A POINT APPROXIMATELY THREE TO FIVE FEET (3'-5') FROM RESTROOM BUILDING CONVERT TO THREE INCH (3") GALVANIZED PIPE. INSTALL NEW GALVANIZED PIPE INTO PIPE CHASE AREA. REPLACE GATE OR BALL VALVES AND INSTALL NEW PR VALVES WITH PRESSURE GAUGES UP-STREAM AND DOWN-STREAM OF PR VALVES. GAS WRAP ON ALL GALVANIZED PIPE.
- NEW SERVICE LINE TO GREENHOUSE BUILDING SHALL BE EQUIPPED WITH A FEBCO 2" RP BACKFLOW PREVENTOR TO SAFEGUARD CULINARY SUPPLY. ALSO INSTALL TWO INCH (2") WYE STRAINER AND PR VALVE UP-STREAM OF BACKFLOW PREVENTOR.

**LEGEND**

SYM.	DESCRIPTION
-----	EXISTING CAST IRON MAINLINE
-----	NEW PVC (BLUE BRUTE C900) SERVICE LINE
-----	NEW IRRIGATION MAINLINE
☒	BACKFLOW PREVENTION ASSEMBLY
⊞	ISOLATION GATE VALVE - SEE IRRIGATION EQUIPMENT SCHEDULE
⊥	BRASS BALL VALVE DRAIN - SEE IRRIGATION EQUIPMENT SCHEDULE
◆	STOP & WASTE VALVE - SEE IRRIGATION EQUIPMENT SCHEDULE
●	EXISTING DRINKING FOUNTAIN

0 100 200 300  
Scale in Feet

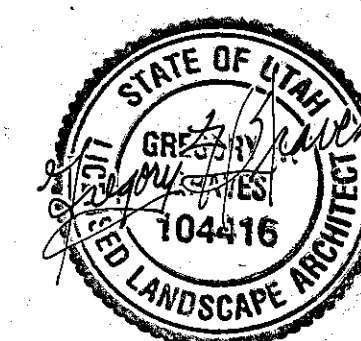

SUGAR HOUSE PARK AUTHORITY  
SUGAR HOUSE PARK  
IRRIGATION MASTER PLAN  
CULINARY LINE LAYOUT

**B BINGHAM**  
ENGINEERING  
SALT LAKE CITY - (801) 532-2520

Design: GHG  
Drawn: DD  
Checked: \_\_\_\_\_  
Reviewed: \_\_\_\_\_

Rev. By Date Remarks  
Date NOV. 1993 Proj. # 1823-006 Sht. 2 of 17



