



• Parks and Recreation •  
JoEllen Grandy • Parks Planner  
Telephone: (801) 336-3926  
Fax: (801) 336-3909

## ADDENDUM #1

**Project :** Layton City Andy Adams Park Improvements, Project 22-04  
(1713 E. 1000 N. – Layton, UT 84041)

**From:** JoEllen Grandy, Parks Planner  
Layton City Parks & Recreation  
465 N. Wasatch Dr.  
Layton, UT 84041  
801.336.3926  
jgrandy@laytoncity.org

**Date:** May 12, 2023

**Re:** Request for Information

- 
1. **The Irrigation Plan Sheet LI101 was updated. Please see the attached documents for those changes.**



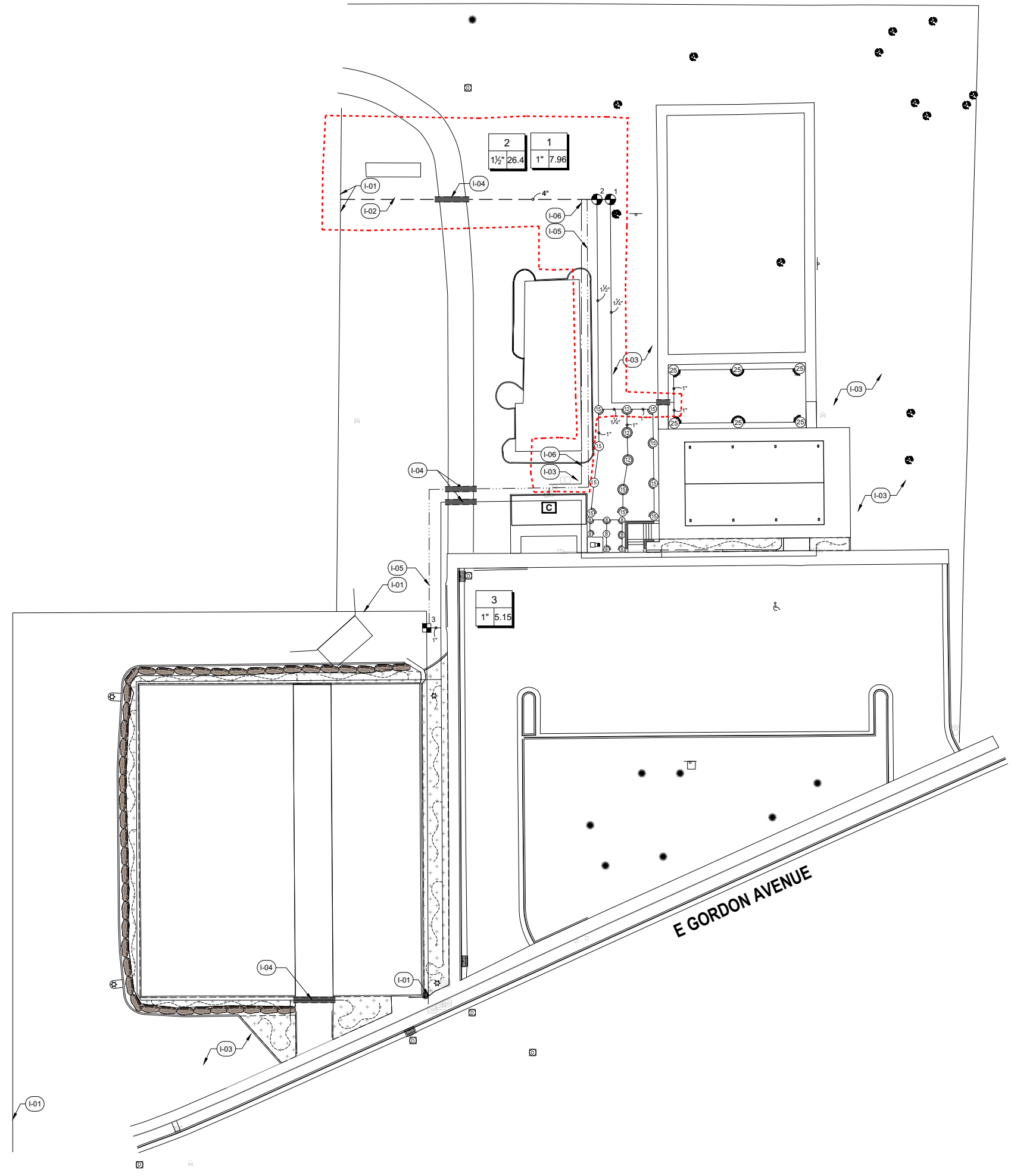

**REFERENCE NOTES SCHEDULE**

SYMBOL	IRRIGATION DESCRIPTION
I-01	EXISTING MAINLINE, CONNECT NEW VALVES
I-02	NEW MAINLINE.
I-03	MODIFY EXISTING IRRIGATION TO ACCOMODATE NEW LANDSCAPE IMPROVEMENTS. CONTRACTOR TO COORDINATE WITH OWNER FOR FIELD VERIFICATION OF EXISTING LATERALS. UTILIZE BEST MANAGEMENT PRACTICES TO MAINTAIN HEAD-TO-HEAD COVERAGE AND MAXIMIZE DISTRIBUTION UNIFORMITY.
I-04	BORE UNDER EXISTING PATH.
I-05	RUN NEW WIRES FROM EXISTING CONTROLLER TO NEW VALVES.
I-06	INSTALL 1" CONDUIT FOR FUTURE USE. CAP ENDS AND TERMINATE IN 10" ROUND VALVE BOX.

**IRRIGATION SCHEDULE**

SYMBOL	MANUFACTURER/MODEL/DESCRIPTION
Q T H F	RAIN BIRD 1806-U-SAM-PRS U8 SERIES TURF SPRAY GIN. POP-UP SPRINKLER WITH CO-MOLDED WIPER SEAL. 1/2IN. NPT FEMALE THREADED INLET. WITH SEAL-A-MATIC CHECK VALVE, AND PRESSURE REGULATING.
Q T H F	RAIN BIRD 1806-U-SAM-PRS U12 SERIES TURF SPRAY GIN. POP-UP SPRINKLER WITH CO-MOLDED WIPER SEAL. 1/2IN. NPT FEMALE THREADED INLET. WITH SEAL-A-MATIC CHECK VALVE, AND PRESSURE REGULATING.
Q T H F	RAIN BIRD 1806-U-SAM-PRS U15 SERIES TURF SPRAY GIN. POP-UP SPRINKLER WITH CO-MOLDED WIPER SEAL. 1/2IN. NPT FEMALE THREADED INLET. WITH SEAL-A-MATIC CHECK VALVE, AND PRESSURE REGULATING.
8 10 12 15	RAIN BIRD 1806-U-SAM-PRS HE-VAN SERIES TURF SPRAY GIN. POP-UP SPRINKLER WITH CO-MOLDED WIPER SEAL. 1/2IN. NPT FEMALE THREADED INLET. WITH SEAL-A-MATIC CHECK VALVE, AND PRESSURE REGULATING.
25	RAIN BIRD 5006-PL-PC-SAM-R-MPR 25
+	RAIN BIRD XCV-PC SINGLE OUTLET, PRESSURE COMPENSATING DRIP EMITTERS. FLOW RATES OF 0.5 GPH=BLUE, 1.0 GPH=BLACK, AND 2.0 GPH=RED. COMES WITH A SELF-PIERCING BARB INLET X BARB OUTLET. WITH CHECK VALVE. Emitter Notes: 20PC emitters (1 assigned to each 1 Gal plant) 20PC emitters (2 assigned to each 5 Gal plant) 20PC emitters (6 assigned to each 2" Cal. plant) 20PC emitters (6 assigned to each B & B, 2"Cal plant)
●	RAIN BIRD PESB 1IN., 1-1/2IN., 2IN. PLASTIC INDUSTRIAL VALVES. LOW FLOW OPERATING CAPABILITY. GLOBE CONFIGURATION. WITH SCRUBBER TECHNOLOGY FOR RELIABLE PERFORMANCE IN DIRTY WATER IRRIGATION APPLICATIONS.
□	EXISTING CONTROLLER EXTERIOR ACCESS TO CONTROLLER ON NORTH SIDE OF BUILDING.
---	IRRIGATION LATERAL LINE: PVC SCHEDULE 40
---	IRRIGATION MAINLINE: PVC SCHEDULE 40
---	PIPE SLEEVE: PVC SCHEDULE 40
---	DRIP DISTRIBUTION TUBING - RAIN BIRD XT-700 (MAXIMUM FLOW 4 GPM (240 GPH), MAXIMUM LENGTH 100')
#	Valve Callout # - Valve Number # - Valve Flow # - Valve Size



**blu line designs**  
planning | landscape architecture | design  
8719 S. Sandy Parkway  
Sandy, UT 84070  
p 801.913.7994

OWNER:  
LAYTON CITY  
437 N WASATCH DR. LAYTON,  
UT 84041

CONTACT:  
JOELLEN GRANDY  
801-336-3628

**ANDY ADAMS PARK IMPROVEMENTS**

1713 E 1000 N  
LAYTON, UT 84041

**REVISIONS**

NO.	DESCRIPTION

Stamp

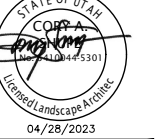

04/28/2023  
Designed By: TH  
Drawn By: TH  
Date: 04/28/2023  
Checked By: RD  
Project No: 22-200

Drawing Title  
**IRRIGATION PLAN**

Drawing number

**LI101**

BID SET

