



• Parks and Recreation •
JoEllen Grandy • Parks Planner
Telephone: (801) 336-3926
Fax: (801) 336-3909

ADDENDUM #1

Project : Layton City Commons Park Improvements, Project 22-05
(437 N. Wasatch Dr. – Layton, UT 84041)

From: JoEllen Grandy, Parks Planner
Layton City Parks & Recreation
465 N. Wasatch Dr.
Layton, UT 84041
801.336.3926
jgrandy@laytoncity.org

Date: May 12, 2023

Re: Request for Information

-
1. **The Irrigation Plan Sheet LI401 was updated. Please see the attached document for those changes.**





blu line designs
 planning | landscape architecture | design
 8719 S. Sandy Parkway
 Sandy, UT 84070
 p 801.913.7994

OWNER:
 LAYTON CITY
 437 N WASATCH DR, LAYTON,
 UT 84041

CONTACT:
 JOELLEN GRANDY
 801-338-3928

REFERENCE NOTES SCHEDULE

- | SYMBOL | IRRIGATION DESCRIPTION |
|--------|--|
| I-01 | APPROXIMATE LOCATION OF 18" HDPE SECONDARY WATER MAIN. WATER MAIN TO BE PRESERVED AND PROTECTED. DO NOT DRIVE OVER THE TOP WITH HEAVY EQUIPMENT. |
| I-02 | APPROXIMATE LOCATION OF EXISTING 6" MAINLINE. MAINLINE TO BE PRESERVED AND PROTECTED OUTSIDE OF IMPROVEMENT AREAS. MAINLINE TO BE REROUTED AS NEEDED AROUND PROPOSED IMPROVEMENTS. INSTALL TEMPORARY IRRIGATION AS NEEDED. |
| I-03 | REMOVE EXISTING MAINLINE. |
| I-04 | PROPOSED REROUTING OF MAINLINE. |
| I-05 | FUTURE CONNECTION TO SECONDARY WATER MAIN AS PART OF CULINARY TO SECONDARY CONVERSION. |
| I-06 | INSTALL 1" CONDUIT FROM NEW CONTROLLER LOCATION TO FUTURE SECONDARY CONNECTION TO FACILITATE INSTALLATION OF MASTER VALVE AND FLOW SENSOR. |
| I-07 | INTERCEPT EXISTING WIRE PATH THAT PARALLELS MAINLINE. RUN REW 14 AWG WIRE FROM NEW CONTROLLER LOCATION AND CONNECT TO EACH OF THE WIRES IN THE WIRE PATH (+/- 8 WIRES) THAT SERVE REMAINING ZONES ON NORTH END OF SITE. |
| I-08 | BORE UNDER EXISTING PATH. |
| I-09 | APPROXIMATE LOCATION OF EXISTING HEAD TO REMAIN. ADJUST LOCATION AND TRAJECTORY AS NEEDED TO MAXIMIZE DISTRIBUTION UNIFORMITY AND MAINTAIN HEAD-TO-HEAD COVERAGE. |
| I-10 | APPROXIMATE LOCATION OF EXISTING HEAD TO BE REMOVED. FOR SINGLE HEAD WITH ADDITIONAL DOWNSTREAM HEADS: REMOVE HEAD AND SWING ASSEMBLY, CAP SPRINKLER CONNECTION AT LATERAL LINE. FOR MULTIPLE HEADS: CUT AND CAP LATERAL LINE IMMEDIATELY AFTER LAST HEAD. FOR COMPLETE ZONE: REMOVE VALVE, VALVE BOX, HEADS, AND PIPES EXPOSED DURING THE COURSE OF CONSTRUCTION. |

IRRIGATION SCHEDULE

- | SYMBOL | MANUFACTURER/MODEL |
|--------|--|
| | RAIN BIRD R-VAN-STRIP 1806-SAM-P45 |
| | RAIN BIRD R-VAN18 1806-SAM-P45 |
| | RAIN BIRD R-VAN24 1806-SAM-P45 |
| | RAIN BIRD 5006-PL-PC-SAM-MPR 25 |
| | RAIN BIRD 5006-PL-PC-SAM-MPR 30 |
| | RAIN BIRD 6504-PC, FC-SS 06 |
| | RAIN BIRD 6504-PC, FC-SS 10 |
| | RAIN BIRD 6504-PC, FC-SS 14 |
| SYMBOL | MANUFACTURER/MODEL/DESCRIPTION |
| | RAIN BIRD XCV-PC
AREA TO RECEIVE DRIP EMITTERS |
| | RAIN BIRD XBCV-PC
SINGLE OUTLET, PRESSURE COMPENSATING DRIP EMITTERS. FLOW RATES OF 0.5 GPH=BLUE, 1.0 GPH=BLACK, AND 2.0 GPH=RED. COMES WITH A SELF-PIERCING BARB INLET X BARB OUTLET. WITH CHECK VALVE |
| | 20PC emitters (6 assigned to each B & B, 2" Cal plant)
20PC emitters (6 assigned to each B&B, 2" Cal plant)
20PC emitters (1 assigned to each 1 Gal plant)
20PC emitters (2 assigned to each 5 Gal plant) |
| SYMBOL | MANUFACTURER/MODEL/DESCRIPTION |
| | RAIN BIRD PESB
1IN., 1-1/2IN., 2IN. PLASTIC INDUSTRIAL VALVES. LOW FLOW OPERATING CAPABILITY, GLOBE CONFIGURATION, WITH SCRUBBER TECHNOLOGY FOR RELIABLE PERFORMANCE IN DIRTY WATER IRRIGATION APPLICATIONS. |
| | RAIN BIRD 44-LRC
1IN. BRASS QUICK-COUPLING VALVE, WITH CORROSION-RESISTANT STAINLESS STEEL SPRING, LOCKING THERMOPLASTIC RUBBER COVER, AND 2-PIECE BODY. |
| | EXISTING WEATHERTRAK ETPRO3 WINEW EXPANSION RELOCATE FROM EXISTING LOCATION JUST EAST OF THE DAVIS ARTS COUNCIL BUILDING. EXPAND 18 STATION TO 30 STATION CONTROLLER BY PROVIDING ADDITIONAL 24 STATION OUTPUT BOARD AND SUPPLEMENTAL 6-STATION KEY. WIRE TO ALL NEW AND EXISTING ZONES TO REMAIN. |
| | IRRIGATION LATERAL LINE: PVC SCHEDULE 40 |
| | IRRIGATION MAINLINE: CLASS 200 PVC |
| | PIPE SLEEVE: PVC SCHEDULE 40 |
| | DRIP DISTRIBUTION TUBING - RAIN BIRD XT-700 (MAXIMUM FLOW 4 GPM (240 GPH), MAXIMUM LENGTH 100') |
| SYMBOL | Valve Callout |
| | Valve Number |
| | Valve Flow |
| | Valve Size |

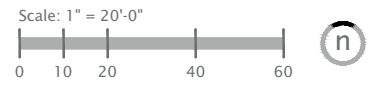
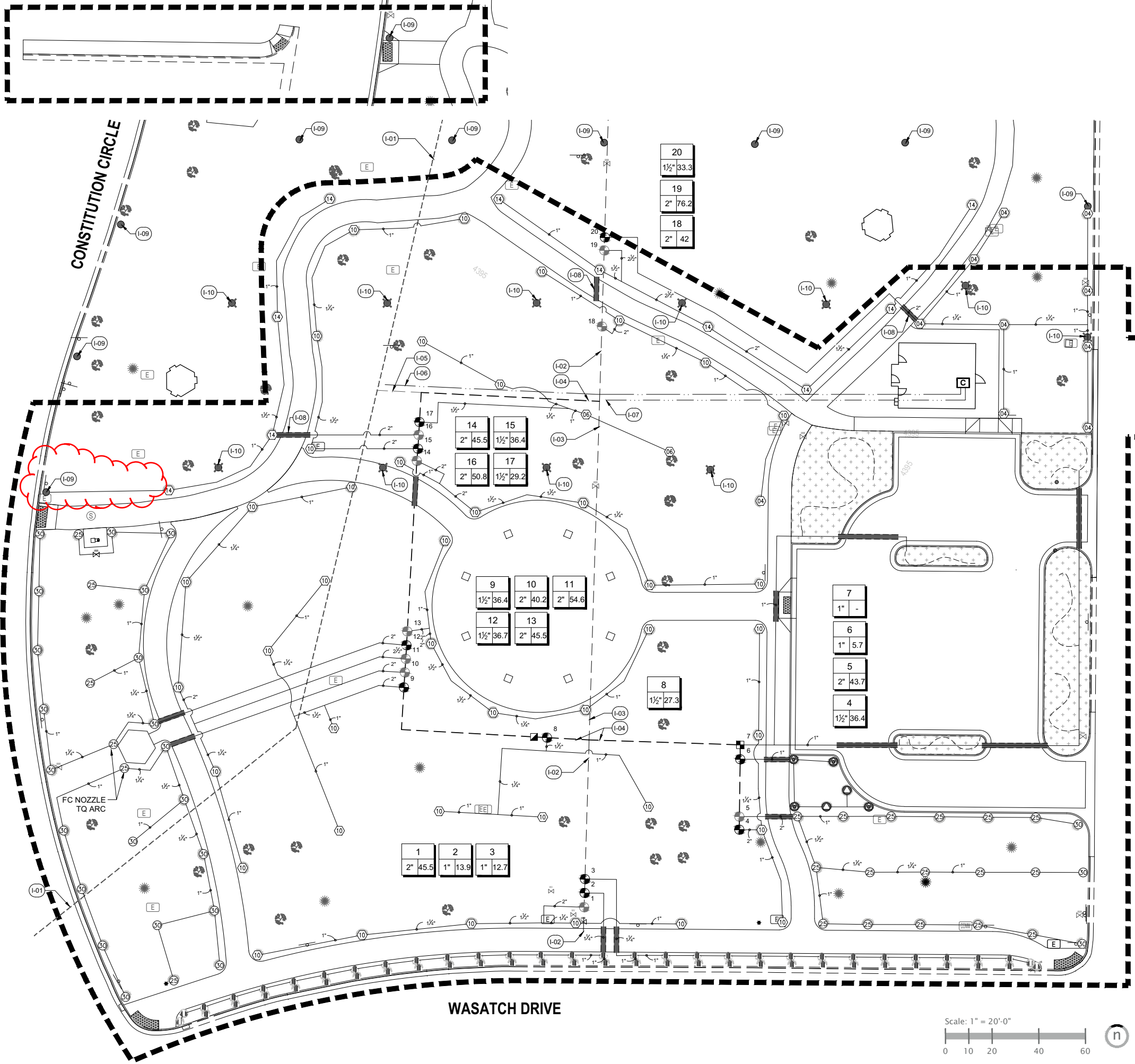

**LAYTON COMMONS PARK
 IMPROVEMENTS**
 437 N WASATCH DR, LAYTON, UT 84041

REVISIONS

NO.	DATE	DESCRIPTION

Stamp: STATE OF UTAH, CORP. A, J. Grandy, Licensed Landscape Architect, 04/28/2023

Designed By: TH
 Drawn By: TH
 Date: 04/28/2023
 Checked By: RD
 Project No: 22-198

Drawing Title
**IRRIGATION
 PLAN
 ENLARGEMENT**

Drawing number
LI401

BID SET